

Thermoschneidegriff ZTS 25 zur Integration in eine Anlage des Kunden /
Thermocutter ZTS 25 for integration in a machine of the customer
Coltello a lama calda ZTS 25 per integrazione su macchina cliente

Anschließbar an das Grundgerät GG 2 / 230V oder 115V /
 To be connected to the Base Unit GG 2 / 115V or 230V
 Connessione a unità di base GG 2 / 115V or 230V

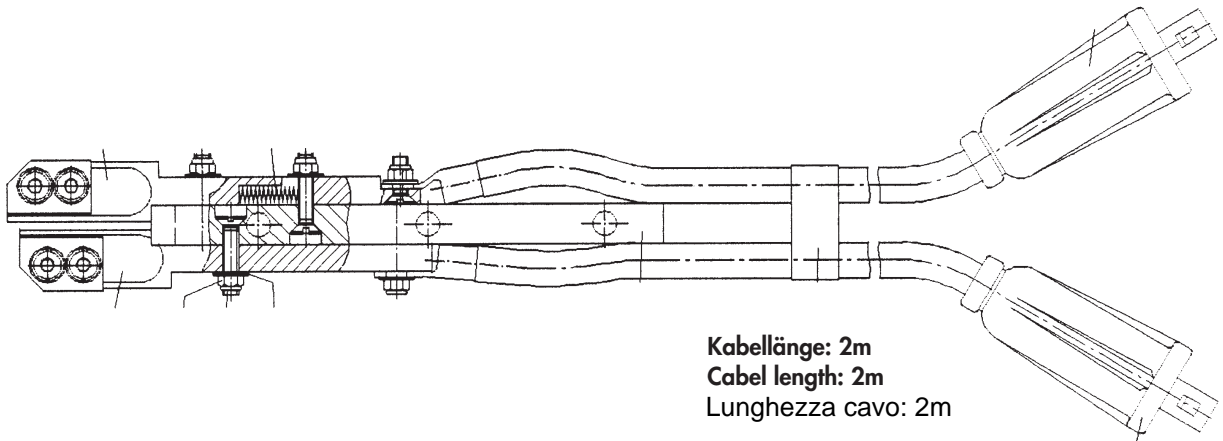

Grundplatte des **Thermoschneidegriffs ZTS 25** mit Befestigungsbohrungen /
 Base plate of **Thermocutter ZTS 25** with mounting holes (dimensions in mm)
 Piastra di base di **Coltello a lama calda ZTS 25** con fori per montaggio
 (dimensioni in mm)

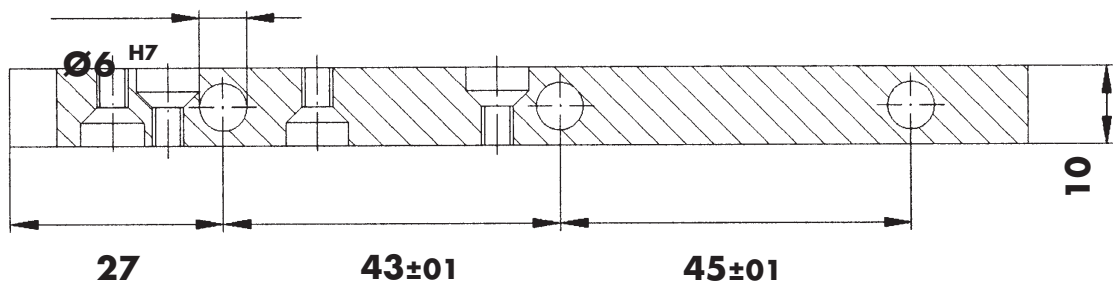

Optional Robotic Handle

